



.	.
1	4
1.1	4
1.2	5
1.3	6
2	7
3	8
4	8
5	9
5.1	9
5.2	9
5.3	10
5.4	10
6	11
6.1	11
6.2	11
6.3	12
6.4	12
7	13

1.

1.1

FS11SVT	1-	SM	FS11SVR
FS12SVT	2-	SM	FS12SVR
FS14SVT	4-	SM	FS14SVR
FS18SVT	8-	SM	FS18SVR FS14SVR
FS11MVT	1-	MM	FS11MVR
FS12MVT	2-	MM	FS12MVR
FS14MVT	4-	MM	FS14MVR
FS18MVT	8-	MM	FS14MVR FS18MVR

1.2

FS11SVR	1-	SM	FS11SVT
FS12SVR	2-	SM	FS12SVT
FS14SVR	4-	SM	FS14SVT
FS18SVR	8-	SM	FS18SVT FS14SVT
FS11MVR	1-	MM	FS11MVT
FS12MVR	2-	MM	FS12MVT
FS14MVR	4-	MM	FS14MVT
FS11MVR	1-	MM	FS11MVT

	FS	X	X	X	X	X	X
		#					
- (1-8)			#				
(S,M)				#			
/					#		
(R/T)						#	
(-R) 19"							#

FS12SVT - 2- SM ()
 FS14MVR-R - 4- ()
 19"

2.

190 – 240 V

8

3

1
2
3
4

1
1
1
1

4

180 125 52 . 4 (139 113) . 1, .1.



1.

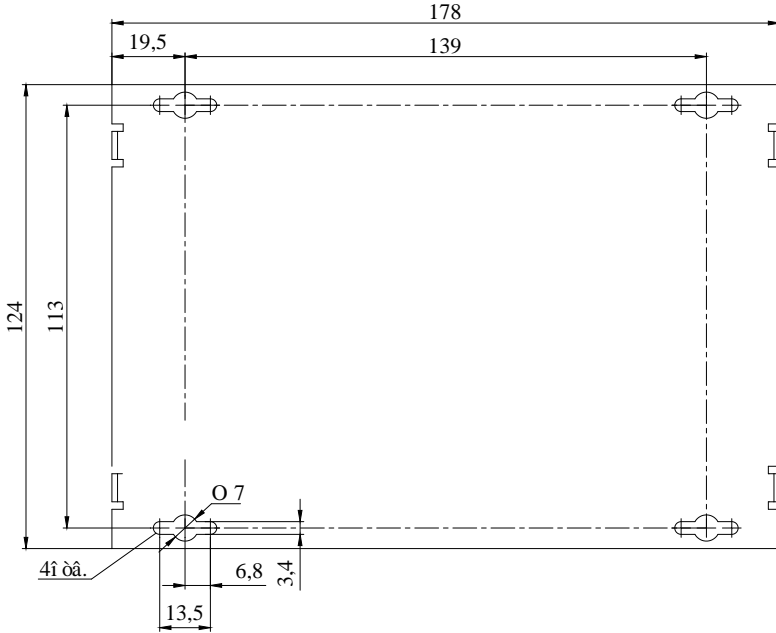

. 1.

5

!

1.

5.1

220 VAC.

“POWER”.

5.2

75)

BNC-

“VIDEO IN”

“Indicator”

5.3

75) BNC- "VIDEO OUT" ("Indicator"

5.4

FC(ST) - "OPTICAL OUT"
FC(ST) - "OPTICAL IN"
"CARRIER".

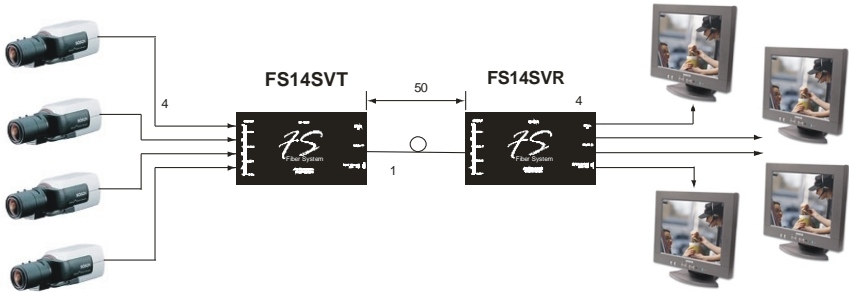

6

6.1

FS11SVT	190 – 240 , 50	8
FS11SVR	190 – 240 , 50	8
FS12SVT	190 – 240 , 50	8
FS12SVR	190 – 240 , 50	8
FS14SVT	190 – 240 , 50	8
FS18SVT	190 – 240 , 50	16
FS14SVR	190 – 240 , 50	8
FS18SVR	190 – 240 , 50	16
FS11MVT	190 – 240 , 50	8
FS11MVR	190 – 240 , 50	8
FS12MVT	190 – 240 , 50	8
FS12MVR	190 – 240 , 50	8
FS14MVT	190 – 240 , 50	8
FS18MVT	190 – 240 , 50	16
FS14MVR	190 – 240 , 50	8
FS18MVR	190 – 240 , 50	16

6.2

- -40 +60° .
 - -50 +65° .
 (+25°) - 0 95%

6.3

	1	2	4	8
/ (R . / R .)	75/75	75/75	75/75	75/75
	250	250	250	250
(/)	1 +/- 20%	1 +/- 20 %	1 +/- 20 %	1 +/- 20 %
(-3)	50 -6,5	50 -6,5	50 -6,5	50 -6,5
/	>48	>48	>48	>48
	-	>48	>48	>48
	<2%	<2%	<2%	<2%

6.4

FS11SVT	0,4 (-4)	FS11SVR	2 (-27)	9/125	1310	23	
FS12SVT	0,4 (-4)	FS12SVR	2 (-27)				
FS14SVT	0,4 (-4)	FS14SVR	2 (-27)				
FS18SVT	0,4 (-4)	FS18SVR	2 (-27)				
FS11MVT	0,4 (-4)	FS11MVR	8 (-21)	62.5/125		1310	17
FS12MVT	0,4 (-4)	FS12MVR	8 (-21)				
FS14MVT	0,4 (-4)	FS14MVR	8 (-21)				
FS18MVT	0,4 (-4)	FS18MVR	8 (-21)				

7

- 5

- 1

119415

.. .36

.: (495) 632-01-10 : (495) 632-01-10

email: office@fibersystem.ru